

ADF10 & ADF11 DIESEL FILTER/SEPARATORS

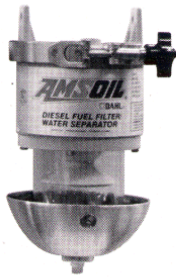

ADF10
Diesel Fuel
Filter/Water Separator



ADF11
Diesel Fuel Filter/Water Separator
U.L. Listed and U.S. Coast Guard
Accepted for Marine Applications

ADF10 & ADF11

ADF10 Standard Diesel Fuel Filter/Water Separator.

ADF11 Marine Diesel Fuel Filter/Water Separator. U.L. Listed and U.S. Coast Guard Accepted. Marine Version of the ADF10 Diesel Fuel Filter/Water Separator.

Flow Rates

- **Single ADF10 Series:**
Recommended:40 GPH (U.S.) (151 LPH)
Maximum:65 GPH (U.S.) (246 LPH)

Specifications

- **Flow Resistance:**0.75 in. Mercury @ 40 GPH
- **Maximum Working Pressure:**25 PSI (172 kPa)
- **Temperature Range:**.....-50° to +225°F (-45 to +107C)
- **Port Thread:**
Single Units:9/16-18 w/O-Ring Boss
- **Height:**.....12 1/2 in. (317.5 mm)
- **Width:**.....5 1/2 in. (139.7 mm)
- **Depth:**.....6 1/2 in. (165.1 mm)
- **Element Removal Clearance:**1 1/2 in. (38.1 mm)
- **Sump Capacity:**8 oz. (236 ml)

Service Parts

- **Elements:**
DE-10*2 Micron Element
DE-1110 Micron Element
Recommended Service Interval:500 hours
or 20,000 miles
- **Gaskets:**
DP-310Complete Gasket Kit

ADF10 & ADF11

Mounting Hole Pattern
Clearance for 5/16 in.
Diameter Fasteners

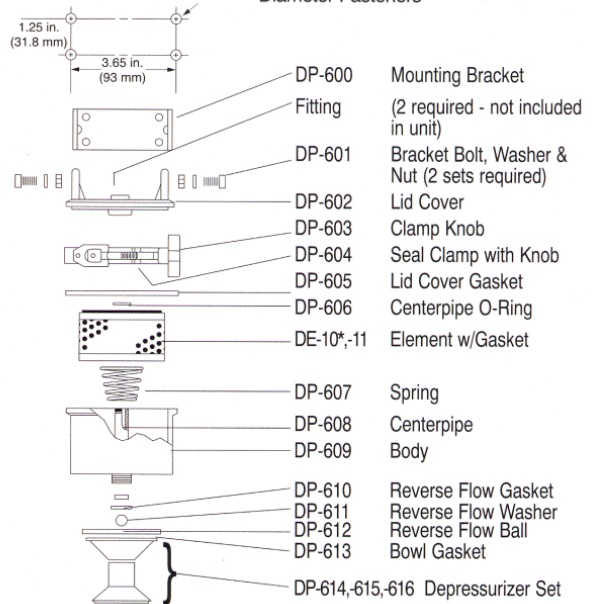

ADF10

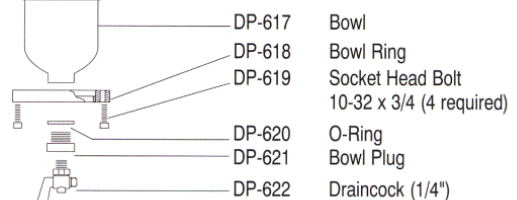

ADF11

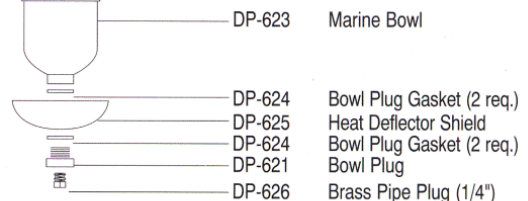

* Standard with Unit