



ADF20 & ADF21 DIESEL FILTER/SEPARATORS



ADF20
Diesel Fuel
Filter/Water Separator



ADF21
Diesel Fuel Filter/Water Separator
U.L. Listed and U.S. Coast Guard
Accepted for Marine Applications

ADF20 & ADF21

ADF20 Standard Diesel Fuel Filter/Water Separator.

ADF21 Marine Diesel Fuel Filter/Water Separator.
U.L. Listed and U.S. Coast Guard Accepted.
Marine Version of the ADF20 Diesel Fuel
Filter/Water Separator.

Flow Rates

- **Single ADF20 Series:**
Recommended:120 GPH (U.S.) (454 LPH)
Maximum:200 GPH (U.S.) (757 LPH)

Specifications

- **Flow Resistance:**1.0 in. Mercury @ 120 GPH
- **Maximum Working Pressure:**25 PSI (172 kPa)
- **Temperature Range:**.....-50° to +225°F (-45 to +107C)
- **Port Thread:**
Single Units:7/8-14 w/O-Ring Boss
- **Height:**.....16 3/4 in. (425.5 mm)
- **Width:**.....7 1/2 in. (190.5 mm)
- **Depth:**.....7 3/4 in. (196.9 mm)
- **Element Removal Clearance:**2 1/2 in. (63.5 mm)
- **Sump Capacity:**24 oz. (708 ml)
- **Top to Inlet CL:**.....2 5/8 in. (66.7 mm)
- **Top to Outlet CL:**.....2 5/8 in. (66.7 mm)

ADF20 & ADF21

Mounting Hole Pattern
Clearance for 3/8 in.
Diameter Fasteners

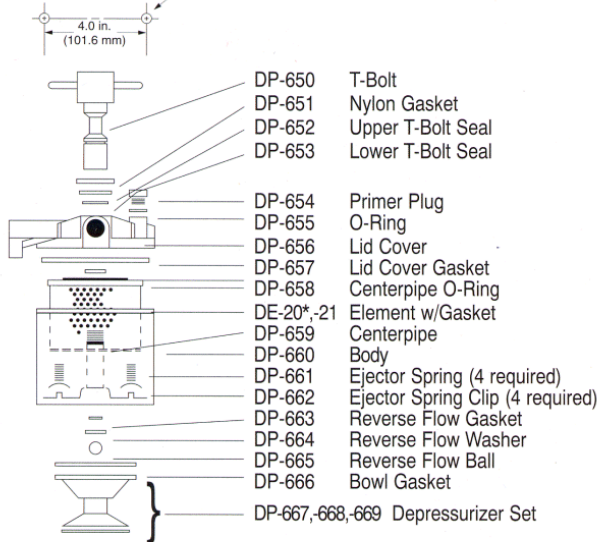

ADF20

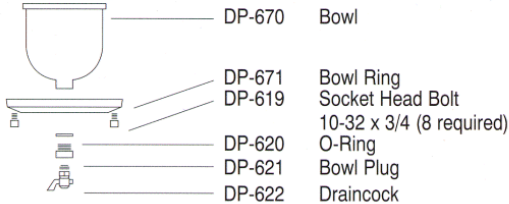

ADF21

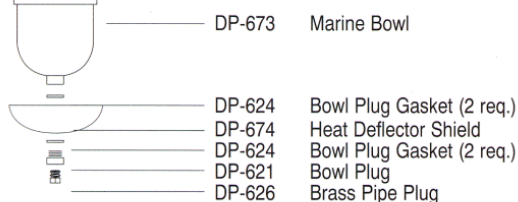

Service Parts

- **Elements:**
DE-20*2 Micron Element
DE-2110 Micron Element
Recommended Service Interval:1,000 hours
or 40,000 miles
- **Gaskets:**
DP-320Complete Gasket Kit

* Standard with Unit